

- DECK MOUNTED SERVICE SINK FAUCET
- GN8BVB RIGID/SWING VACUUM BREAKER SPOUT
- 1000 INDEXED WING HANDLES
- QUATURN UNITS
- POLISHED CHROME FINISH OR AS SPECIFIED

- E2-2 HOSE THREAD OUTLET
- ANSI A112.18.1
- CSA B125

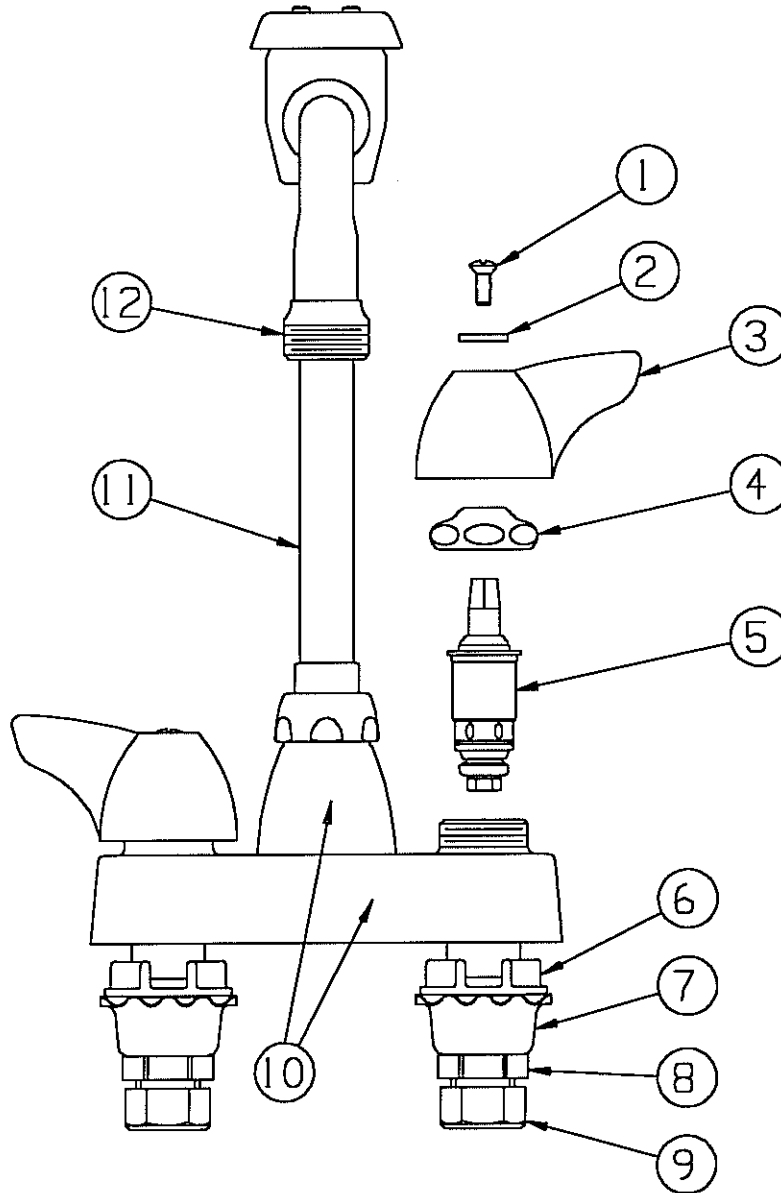

NO.	PART NO.	DESCRIPTION	NO.	PART NO.	DESCRIPTION
1	420-010	SCREW	8	49-004	LOCKNUT
2	633-023	INDEX BUTTON (RED)	9	49-005	COUPLING NUT
	633-123	INDEX BUTTON (BLUE)	10	—	BODY & SPOUT BASE ASSY.
3	1000PR	WING HANDLE (INCLUDES INDEX BUTTONS & SCREWS)	11	GN8BVB	SPOUT ASSEMBLY
4	1-214	CAP	12	E2-2	HOSE THREAD OUTLET
5	1-099XT	QUATURN UNIT R.H.			
	1-100XT	QUATURN UNIT L.H.			
6	555-113	STILT WASHER			
7	1797-114	BASIN COCK WASHER			