

BEFORE YOU BEGIN

The following instructions are used to replace the 30668 tank fitting on K-3383-EB Palarre, K-3400-PB Pompton, and K-3385-EB Rochelle. These instructions also cover replacement of the 30669 used on the K-3390-EB Champlain. Before beginning replacement procedures, turn off water supply. Flush the toilet to drain water from tank. Remove remaining water.

REMOVING OLD TANK FITTING

See Fig. #1. Disconnect float ball from float rod.

Remove locknut securing hush tube to tank (not on Champlain).

Remove trip lever chain from trip lever.

Loosen clamp screw in valve seat until seat clamp and rubber seat gasket falls off. Disconnect rim flush tube.

Remove rim flush tube.

Remove old tank fitting, seat clamp and rubber seat gasket from inside of tank.

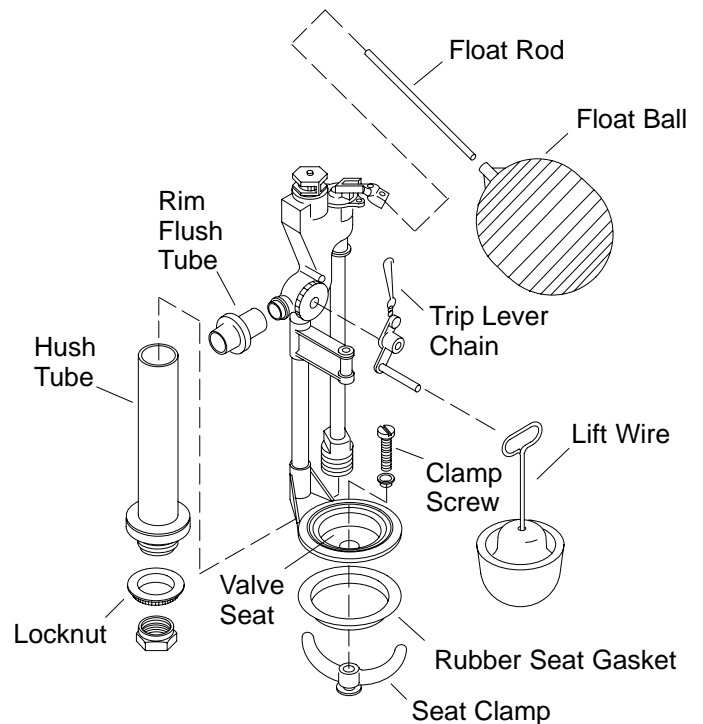

Fig. #1

INSTALLING NEW TANK FITTING

FOR PALARRE, POMPTON, AND ROCHELLE TOILETS

See Fig. #1. See Fig. #2. Insert lift wire through hole in guide. Insert rotor arm into lift wire.

Place long end of rim flush tube over rim flush opening on valve.

Assemble rubber seat gasket onto seat.

Thread rubber gaskets onto top and bottom of hush tube. Slide hush tube over supply tube. **NOTE:** Champlain models do not have a hush tube. A soft copper supply tube loops over the outside back of the tank.

Set the seat clamp into center of tank outlet hole.

Place valve into tank making sure that the rim flush tube is inserted into the rim flush supply; supply tube is through open supply hole in bottom of tank; and the clamp screw hole aligns with the opening in the seat clamp.

With plastic collar on clamp screw, insert screw through clamp screw hole and into seat clamp and tighten.

Attach flush ball to lift wire.

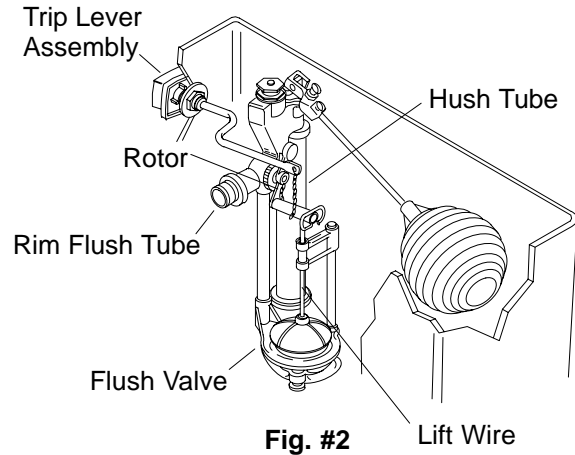

Fig. #2

FOR CHAMPLAIN TOILETS

See Fig. #1. See Fig. #3. On Champlain models, the copper tubing may have to be bent slightly because of possible deforming during shipping.

Loop trip lever chain under rotor arm and clip to trip lever.

Insert float rod into float guide. Tighten screw. Thread on float ball. **NOTE:** Adjust float rod to obtain the correct water level. Timing is adjusted by turning the timing screw downward to decrease flow or upward to increase flow.

Reconnect closet valve to the water supply. Turn on supply.

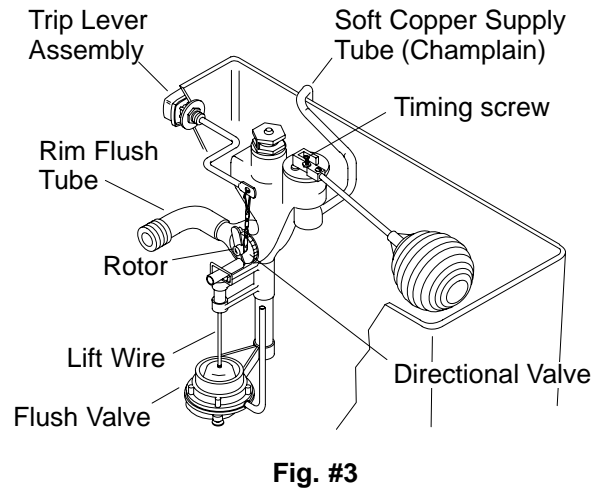

Fig. #3