

This unit offers NO anti-siphon or backflow protection.



Freezeless Wall Faucet Model 14

The freezeless Woodford Model 14 is designed and intended for year-round residential irrigation purposes regardless of outside temperature. This faucet will not rupture from freezing when the valve is shut off and the hose is removed.

SPECIFICATIONS:

- Manufactured under one or more of the following patents: 3,208,715; 3,278,201; 5,590,679; 5,632,303
- CSA Approved 

FEATURES:

- 3/4" male hose thread nozzle
- Stainless steel seat - eliminates wire draw
- EPDM packing to prevent leaking
- Full circle operating threads on valve body and retainer
- No-lead solder
- Standard "O" size seat washer
- Powder-coated, die cast aluminum handle
 - Optional Tee Key available (extra charge)
- Adjustable polycarbonate wall flange
- **MAX PRESSURE** - 125 p.s.i.
- **MAX TEMPERATURE** - 120° F

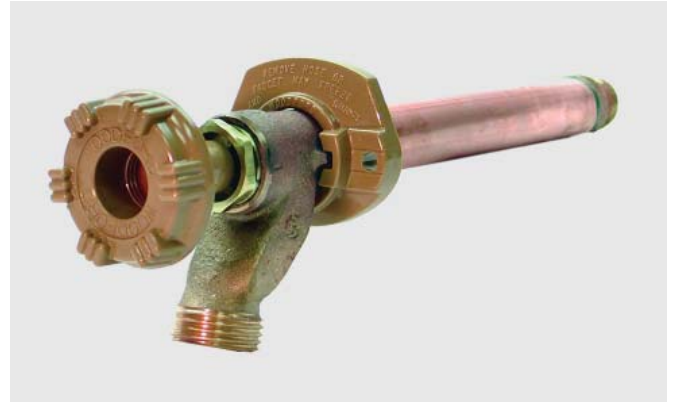

WARNING - Faucet must be installed with downward pitch toward nozzle and hose must be removed in freezing weather or faucet may freeze and burst.
Not intended for continuous use applications.

Rough-In Dimensions

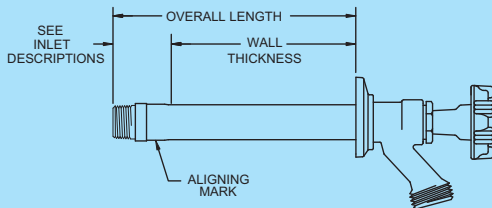

Wall Thickness (inches)

4	6	8	10	12	14	16	18	20	22	24
1.2	1.3	1.4	1.5	1.6	1.7	1.8	1.9	2.0	2.1	2.2

Shipping Wt. Ea. (lbs)

*Overall Length Dimension: Add wall thickness and inlet option length shown in chart above.

**For instructions go to
www.woodfordmfg.com or call 1-800-621-6032**

Inlet Descriptions

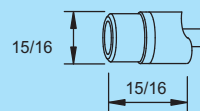

C Inlet
COMBINATION
Copper Sweat Fitting
1/2" K, L or M Inside
3/4" M Only Outside

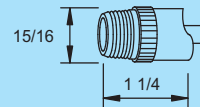

CP Inlet
COMBINATION
1/2" Male Pipe Thread
1/2" Female Sweat

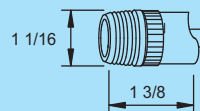

CP3 Inlet
COMBINATION
3/4" Male Pipe Thread
3/4" Female Sweat

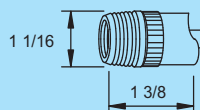

P Inlet
COMBINATION
1/2" Female Pipe Thread
3/4" Male Pipe Thread

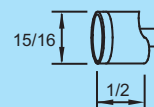

C1 INLET
1/2" Female Sweat Fitting

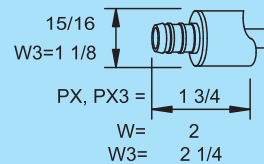

PX Inlet
1/2" PEX Tube Fitting
PX3 INLET
3/4" PEX Tube Fitting
W Inlet
1/2" Wirsbo Tube Fitting
W3 INLET
3/4" Wirsbo PEX Tube Fitting
R Inlet
1/2" Rehau Tube Fitting

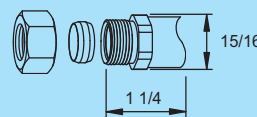

CM Inlet
COMBINATION
1/2" Compression Fitting
1/2" Copper Sweat Fitting

When ordering, specify model, inlet and wall thickness.