

## SUBMITTAL DATA

GMV-ND12T/C-T(U) for use with VRF Outdoor Unit  
12000 BTU/H One Way Cassette Unit

Job Name <input type="text"/>	Location <input type="text"/>	Date <input type="text"/>
Purchaser <input type="text"/>	Engineer <input type="text"/>	
Submitted to <input type="text"/>	For <input type="text"/>	
Unit Designation <input type="text"/>	Schedule No. <input type="text"/>	



YAP1F

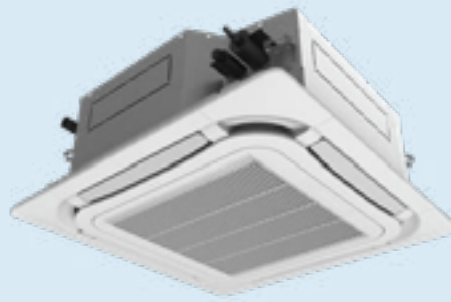

GMV-ND12T/C-T(U)



XK46 (Optional)

### GENERAL FEATURES

- 360° Air Supply
- Independent Swing Control
- Ultra-low noise operation
- DC Quiet Drainage Pump
- Wireless Remote with LCD Display
- Wired Controller Options
- Wi-Fi Included (Factory Installed)
- Based on Outdoor Unit Performance
- Based on Outdoor Unit Performance
- Coil (Indoor and Outdoor) Copper Tube / Aluminum Fin
- Blue Colored Fin - 500 Hrs Salt Spray Tested

## SPECIFICATIONS, FEATURES & FUNCTION SUMMARY

SPECIFICATIONS		GMV-ND12T/C-T(U)		FEATURES & FUNCTIONS SUMMARY		GMV-ND12T/C-T(U)		
System Type		HEAT PUMP						
<b>SYSTEM PERFORMANCE</b>				<b>SYSTEM FEATURES</b>				
Cooling	Nominal	Btu/h	12000	Wired Controller Interface	Yes			
	Capacity @95°F	Btu/h		WiFi Included	No			
Heating	Nominal	Btu/h	13500	NEW! Easy Service Access	Yes			
	Capacity @5°F	Btu/h		Indoor Fan Type	Centrifugal			
	Capacity @17°F	Btu/h		Multi Fan Speeds	4 Speeds			
	Capacity @47°F	W		Indoor Unit Display	No			
SEER2				Auxiliary Electrical Heater	No			
EER2				Ventilation (Outdoor Air)	No			
HSPF2				<b>REMOTE CONTROLLER FUNCTIONS</b>				
COP @5°F	System Performance Based on the Connected Outdoor Unit Performance			Auto Mode	Yes			
COP @47°F				Auto Fan	Yes			
Cooling Temperature Range				°F	Auto Swing (Horizontal Auto Swing)	No		
Heating Temperature Range				°F	Auto Swing - 180° (Vertical Auto Swing)	Yes		
Refrigerant Type				R410A		Clock	Yes	
<b>INDOOR UNIT</b>		<b>GMV-ND12T/C-T(U)</b>		Dry Mode	Yes			
Air flow (Min-Max)	CFM	353 - 471		Dry Anti-Mildew (X-Fan) Mode	Yes			
Sound Pressure Level (Min - Max)	dB(A)	28 - 33		Energy Saving Mode	Yes			
Condensate Drain Size (OD)	in	1		Dirty Filter Alert	No			
Dehumidification	pt/hr			Fan Speed Control (7 Speeds)	Yes			
External Dimensions (WxHxD)	in	33-1/8 x 9-1/2 x 33-1/8		I Feel Function	Yes			
Package Dimension (W x H x D)	in	37-7/8 x 12-3/4 x 37-7/8		Privacy Lock	Yes			
Net Weight	lbs	94		Quiet Mode	Yes			
Gross Weight	lbs	108		Room Temperature Display	No			
<b>CASSETTE GRILLE (REQUIRED)</b>		<b>TF06</b>		Sleep Mode	Yes			
Grille Dimension (W x H x D)	in	37-3/8 x 2-1/2 x 37-3/8		3 Sleep Mode Options	Yes			
Package Dimension (W x H x D)	in	40-7/8 x 4-3/8 x 40-5/8		Timer Mode	Yes			
Weight (Net / Gross)	lbs	13 / 21		Turbo Mode	Yes			
<b>REFRIGERANT PIPING</b>				Display On/Off Control	Yes			
Line Set Sized by the Indoor Unit (Liquid - Gas)	in	1/4 - 1/2		Freeze Guard Mode	Yes			
<b>ELECTRICAL</b>				Power Failure Mode	Yes			
Power Supply	208-230V / 1Ph / 60Hz							
MCA	A	0.8						
MOCP	A	15						

# DIMENSIONS & CLEARANCES

## INDOOR UNIT

Unit: inch

GMV-ND12T/C-T(U)

DIMENSIONS

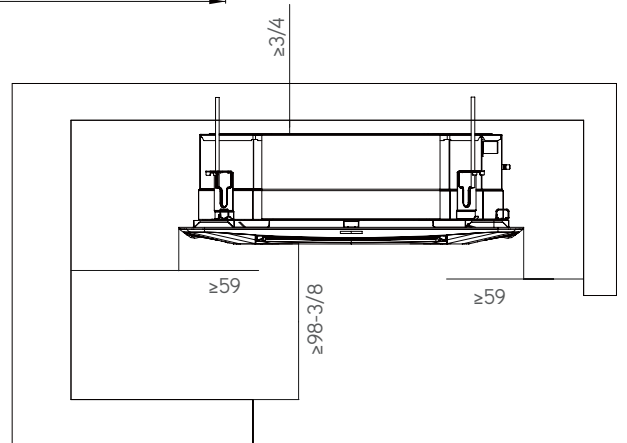
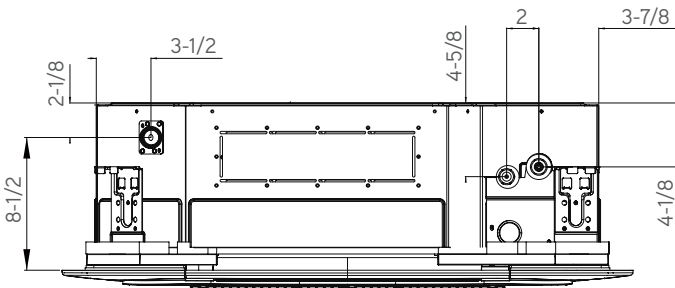
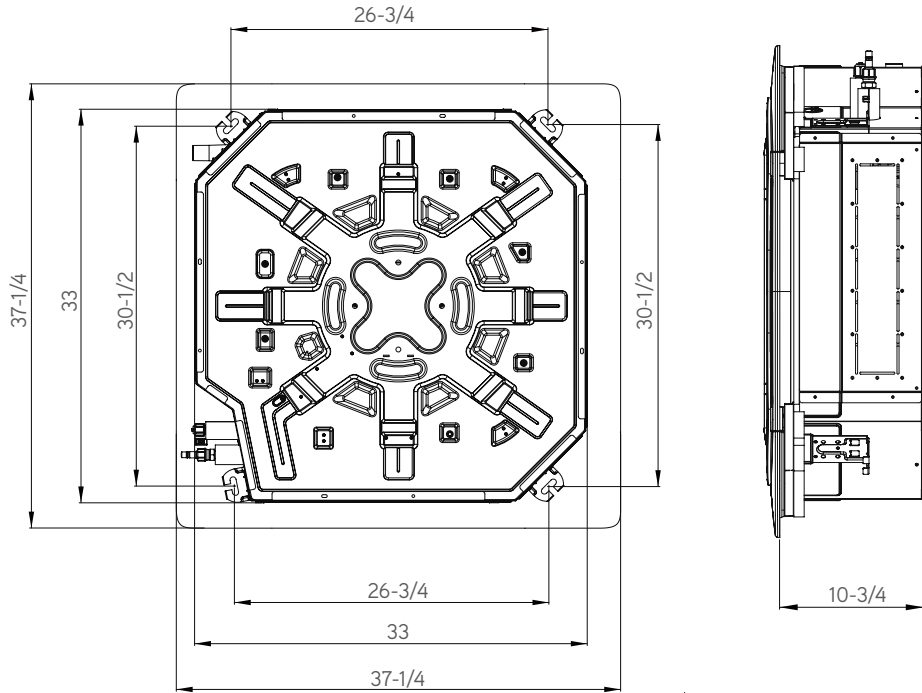

## INDOOR UNIT

Minimum clearance

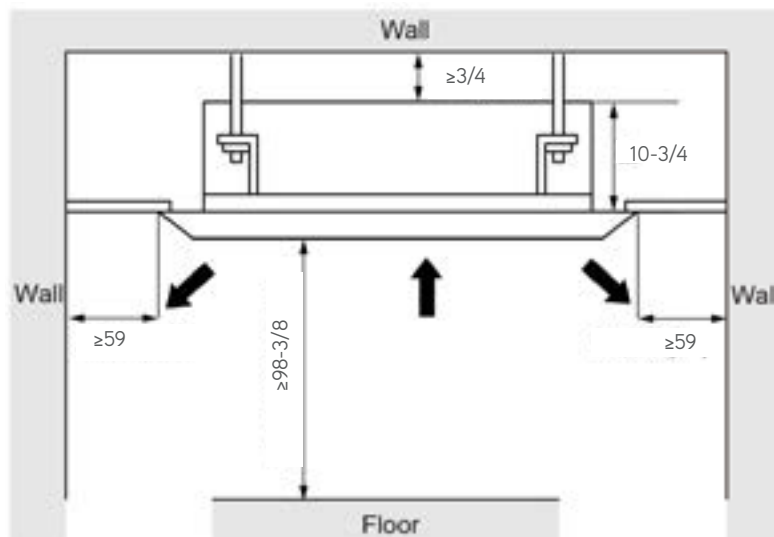

Specifications are subject to change without notice. Manufacturer reserves the right to discontinue or modify specifications or designs without notice or without incurring obligations. All Rights reserved.

[GREECOMMERCIAL.COM/SYSTEM-DOCUMENTATION](http://GREECOMMERCIAL.COM/SYSTEM-DOCUMENTATION)