

Honeywell Home



T6 Pro Z-Wave™

Programmable Thermostat

User Guide

TH6320ZW2003

TH6320ZW2007 (with SmartStart)



Actual size 4.09" x 4.09" x 1.06"



Welcome

This user guide is designed to help you get acquainted with your new T6 Pro Z-Wave thermostat. Check out the table of contents on page 2 to browse by topic.

Need help? Get in touch.

Web: honeywellhome.com

Phone: 1-800-468-1502

Social: Twitter: @HoneywellHome, Facebook: Honeywell Home

Table of contents

Thermostat features	3
Thermostat overview	4
Basic thermostat operation	
Adjusting the temperature	4
Program schedule overrides.....	5
Adjusting the temperature in Auto mode	6
Selecting system mode.....	7
Built-in compressor protection	8
Setting the fan	8
Main menu settings	
Z-Wave setup.....	9
Z-Wave connection status.....	10
Main menu overview.....	11
Scheduling options	12
Setting a schedule.....	14
Reset schedule	15
Screen lock settings.....	15
Adjusting backlight brightness	16
Enabling/disabling Adaptive Intelligent Recovery.....	17
Setting the time and date.....	17
Cleaning the thermostat screen.....	18
Choosing Fahrenheit or Celsius	18
Viewing equipment status	19
Viewing thermostat information.....	19
Battery replacement.....	20
Alerts and maintenance reminders	21
Appendices	
Troubleshooting.....	23
5-year warranty.....	24
General system information	25
Regulatory information	25

Thermostat features

The T6 Pro Z-Wave Programmable Thermostat is a Z-Wave Plus™ certified thermostat designed to work with any Z-Wave compliant controller or gateway for easy programming and automation to deliver energy savings and comfort at the same time. The thermostat can be operated in any Z-Wave network together with other Z-Wave certified devices from other manufacturers. All non-battery operated Z-Wave devices (nodes) within the network will act as repeaters regardless of manufacturer to increase reliability of the network. When integrated with the app that controls your Z-Wave controller, it lets you program and control your home's HVAC system as well as control other Z-Wave devices connected to the same Z-Wave controller.

Flexible scheduling: The thermostat is fully programmable when not included into a Z-Wave network. Each day can be programmed for different heating and cooling settings in 4 unique periods (Wake, Away, Home, Sleep). The thermostat scheduling options available differ depending on whether the thermostat is included or excluded from Z-Wave network, on capability of your Z-Wave controller and app to program thermostat.

Displays ambient air temperature, % relative indoor humidity and reports HVAC system status: You can display actual temperature or % relative humidity, or to see whether your cooling / heating system is running.

Auto change from heat to cool: When Auto mode is selected, the T6 Pro Z-Wave thermostat can automatically determine whether your home needs heating or cooling to reach the desired temperature at the right time.

Smart Alerts: The T6 Pro Z-Wave thermostat can alert you when your HVAC system is not working properly and can remind you for things like when to change your furnace filter.

Adaptive Intelligent Recovery: The T6 Pro Z-Wave thermostat learns your heating and cooling cycle times to make sure the system delivers the temperature you want, when you want it. (Available only if the local thermostat schedule is enabled.)

Power method: Designed for battery operation (3 x AA batteries) or for 24 VAC power operation (via a "C" or common wire).

SmartStart: (TH6320ZW2007 model only). After the initial setup and time/date have been set, the TH6320ZW2007 thermostat will initiate SmartStart. Icon in upper right of display will flash. Thermostat stays in SmartStart mode indefinitely until it is included in a Z-Wave network.

Identify thermostat: (TH6320ZW2007 only). If the thermostat is included in a Z-Wave Network. You can choose to identify the thermostat via Z-Wave app. Backlight will flash. Touching display while flashing will stop Identify mode. This is helpful when multiple thermostats are on the same Z-Wave Network.

Excluding thermostat: If the thermostat is connected to a Z-Wave network that you wish to remove it from, select "Menu". Then touch the right arrow until Z-Wave network is shown. Touch "select". The display should show "exclude" if it is currently connected to a Z-Wave network. Touch select to exclude the thermostat from the network.

Thermostat overview

Desired temperature

Shows desired indoor temperature.

Indoor Temperature/ % Relative Indoor Humidity

Touch to display either indoor temperature or % relative indoor humidity.

Z-Wave connection status



Shows Z-Wave connection status.

Adjust temperature

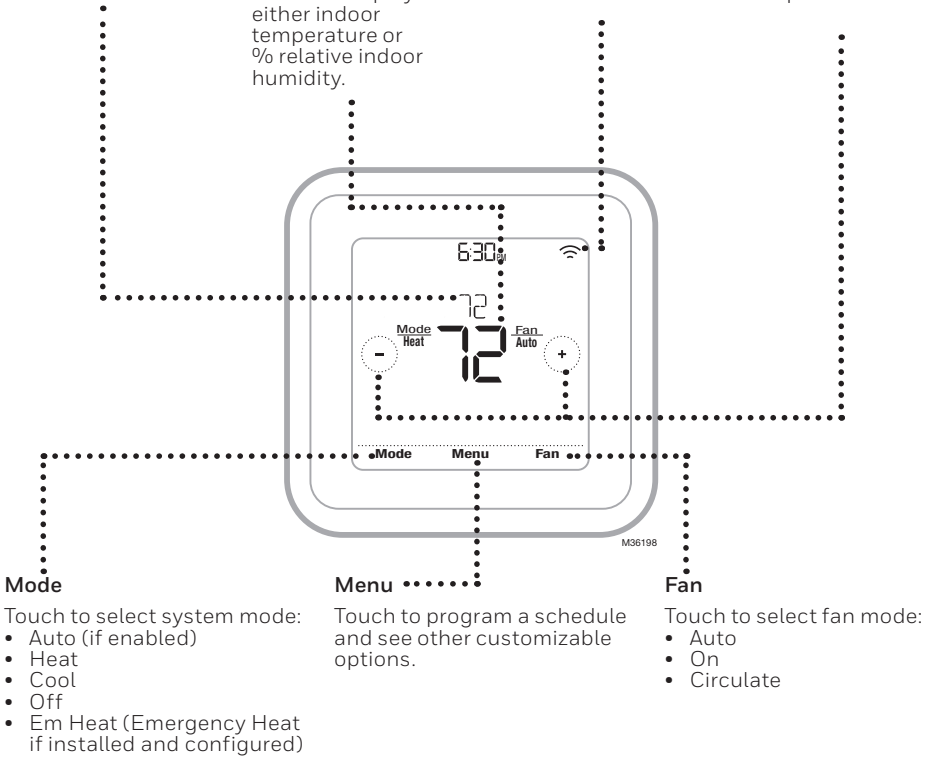
Touch  or  to set your desired temperature.



Adjusting the temperature

To adjust the desired temperature up or down, touch  or  on the thermostat home screen.

How long the change will be held depends on whether your thermostat is included or excluded in Z-Wave network and what schedule type is selected. For more information, see "Scheduling options" on page 12.



Program schedule overrides

If the thermostat is included in Z-Wave network it typically follows the setting on your Z-Wave controller. If you adjust the temperature setting, it overrides the current setting until new state (eg. Home/Away) and/or the new temperature setting is received from Z-Wave controller. Setting of Hold until time and Permanent hold (see below) will not be available on the thermostat screen at this time.

There are several scheduling options available for the thermostat. For more information, see "Scheduling options" on page 12.

If the thermostat is not included in Z-Wave network and the thermostat is following local time based schedule only, you can set what time the new temperature setting will be held until or you can hold the new temperature setting permanently.

Program schedule override (temporary)

- 1 Touch **+** or **-** on the thermostat home screen to set your desired temperature. Hold **Until** will appear together with the time the hold will end.
- 2 To change when the hold will end, touch **Hold Until** and wait until the time starts blinking. Then, touch **+** or **-** to set when you want the hold to end. Touch **Hold Until** once more to confirm changes and return to the home screen.

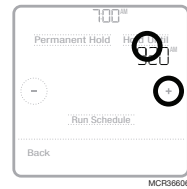
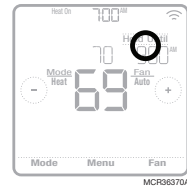

After the hold period ends, the thermostat will automatically return to the program schedule. If you want to cancel the hold, touch **Hold Until** and then touch **Run Schedule**.

Program schedule override (permanent)

- 1 Touch **+** or **-** on the thermostat home screen to reach your desired temperature. **Hold Until** will appear together with the time you want the hold to end.
- 2 Touch **Hold Until**. Permanent Hold will appear on screen. Touch **Permanent Hold** to hold this temperature until you manually change it.

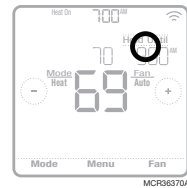

To end permanent hold and return to the program schedule, touch **Permanent Hold** and then touch **Run Schedule**.

Adjusting the temperature in Auto mode

Auto mode (when the thermostat automatically chooses heating or cooling to reach your desired temperature) is disabled by default. If your heating or cooling professional enabled it, you'll see Auto appear as an option under Mode on the thermostat home screen.

To choose your preferred temperatures for both heating and cooling in Auto mode, follow the steps below.

- 1 Touch **Mode** on the thermostat home screen until Auto appears. Then touch **+** or **-** to choose your preferred temperature setting for the mode that's currently active (heating or cooling).
- 2 Next, touch the text area where the active mode is displayed to switch to the inactive mode.
- 3 Touch **+** or **-** to choose your preferred temperature in the other mode. After 5 seconds of inactivity, your setting will take effect, and the thermostat screen will show the set point of the active mode.

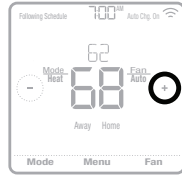

Selecting system mode

Current system mode (Heat, Cool, Off, Em Heat*) is displayed on the thermostat home screen.

The mode that's currently running (Heat On or Cool On) is displayed in the upper-left corner of the thermostat home screen.

To cycle through the available modes, touch **Mode** on the thermostat home screen and select the appropriate mode for your desired temperature.

- **Heat:** Controls the heating system.
- **Cool:** Controls the cooling system.
- **Off:** Turns the heating and cooling systems off.
- **Auto:** When enabled, the thermostat will automatically use heating or cooling to reach the desired temperature.
- **Em Heat:** Controls auxiliary or emergency heat; only available on systems with a heat pump.

Notes:

- Em Heat is only available if the thermostat is configured to control a heat pump and an auxiliary/emergency heat stage.
- When Auto mode is selected, Auto Chg. On will appear in the upper-right corner of the thermostat home screen, and the active mode (Heat or Cool) will display under Mode. To set your temperature preferences in Auto mode, see page 6.

*Em Heat and Auto modes may not appear on the thermostat screen depending on your equipment and how your thermostat was installed.



Built-in compressor protection

If the compressor is restarted too soon after a shutdown, system damage can occur. The built-in compressor protection feature forces the compressor to wait a few minutes before restarting, helping to prevent damage to the heating or cooling system.

During the brief wait period, the thermostat will flash Cool On (or Heat On if you have a heat pump) until the wait period is over, at which point the compressor will turn back on.

Note: The flashing Cool On or Heat On message is also used for startup delay protection if AC power loss occurs.



Setting the fan

Touch **Fan** on the thermostat home screen to cycle through available fan modes until the desired mode is displayed. Your changes will save automatically.

Available fan modes:

- **On:** The fan will run continuously.
- **Auto:** The fan will run only when the heating or cooling system is on.
- **Circ:** The fan will run at random intervals at least 35% of the time to keep air circulating throughout your home.



Z-Wave setup

TH6320ZW2003 model only. TH6320ZW2007 model has SmartStart and will be in the INCLUDE MODE as soon as the thermostat is powered and configured for system type.*

To add to include or remove to exclude the thermostat from Z-Wave network, go to thermostat **MENU/Z-WAVE SETUP**.

- Touch **Select**. You will be asked to set your primary controller to **INCLUDE MODE**. Please refer to the user manual of your Z-Wave controller.
- After inclusion procedure has been initiated on your Z-Wave controller, touch **Select** on the thermostat.
- If the inclusion procedure is successful, "**INCLUDED**", the node ID, and the Z-Wave connected status icon appear on the screen. If the procedure fails, "**FAILED TO INCLUDE**" appears on the screen. If this happens, position the thermostat closer to the Z-Wave controller and repeat the inclusion procedure.
- Your controller will indicate whether the thermostat was successfully added to its network. (Please refer to the user manual of your Z-Wave controller.)

NOTES:

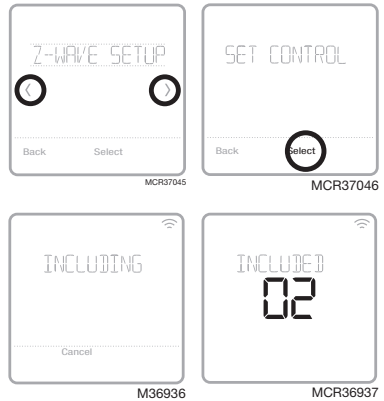

- Once the thermostat is included into the Z-Wave network, it assumes to be programmed from your Z-Wave controller and the program schedule on the thermostat is turned OFF by default. If the thermostat is not included into the Z-Wave network, then this thermostat will function as normal programmable thermostat. For more information, see "Scheduling options" on page 12.
- Before adding the thermostat to a Z-Wave network, check that it does not already belong to one. If the thermostat is included in Z-Wave network, it offers to exclude. If the thermostat is excluded from Z-Wave network, it offers to include. You can also check the status by viewing the **Node ID** located in the thermostat **MENU/DEVICE INFO**. An excluded thermostat should show zero for the Node ID (000).
- Whether you are adding the thermostat for inclusion or removing for exclusion from Z-Wave network, first you have to initiate it on your Z-Wave controller. Please refer to the user manual of your Z-Wave controller.
- For other specific tasks, such as adding the thermostat to home automation scenes or groups, refer to the Z-Wave controller instructions.
- The T6 Pro Z-Wave thermostat works in the optional Z-Wave battery mode or normal power mode based on its power source. The Z-Wave power mode can only be changed when thermostat is **NOT** included in Z-Wave network. You can check the power mode in the thermostat menu under **MENU/DEVICE INFO**.
- If 24 VAC power source is not used or available, the thermostat must be powered by batteries. The thermostat will operate in LSS mode (power-save, sleep mode) to help conserve battery life after it has been included in a Z-Wave network. The Z-Wave radio supports beaming. It allows other devices in the network to wake up the Z-Wave thermostat, accept commands, and then go back to sleep.
- If you need the thermostat to operate AOS mode (always listening mode) to act as signal repeater and to increase network reliability, you need to ask your professional installer to power the thermostat by 24 VAC.

* If using the TH6320ZW2007 with a Z-Wave network that doesn't have SmartStart, select **MENU**, then **Z-WAVE SETUP**, then **START INCLUDING**.



Z-Wave connection status



Z-Wave connection status is located in the upper-right corner of the screen.

-  • Solid icon. Thermostat is included and connected to a Z-Wave network.
-  • Flashing Icon. (TH6320ZW2007 model only.) Thermostat is in the INCLUDE MODE using SmartStart. This occurs after initial setup and time and date are set. Include mode shown on page 9.
- TH6320ZW2003 model only. Thermostat is excluded from a Z-Wave network.
-  • Thermostat is either included in a Z-Wave network but the Z-Wave signal is lost, or is included but AC power is lost (battery used as backup). In this case, Z-Wave radio is turned off to preserve battery life. AC power must be restored or you have to change the power mode. It can be done via excluding thermostat from Z-Wave network and including again in battery power mode where batteries are used as main power source. You can check the actual power mode in the thermostat **MENU/DEVICE INFO**.



Example of thermostat included and connected in a Z-Wave network. MCR37009

Main menu overview

Touch **Menu** on the thermostat screen and then use the  or  arrows to page through the following options.

SCHEDULE

Edit local thermostat program schedule. (Available only if enabled by your local heating or cooling professional.)

AWAY SETTING

Set energy saving temperature settings for when you are away. (Available as a separate Menu item if thermostat is included in Z-Wave network.)

SCREEN LOCK

Lock the screen to limit access to thermostat settings.

Z-WAVE SETUP

Include or exclude the thermostat from Z-Wave network.

BRIGHTNESS

Set the brightness of an inactive backlight. (Available only if the thermostat is powered by 24 VAC.)

RECOVERY

Enable or disable the Adaptive Intelligent Recovery feature. (Available only if the local thermostat schedule is enabled and turned on.)

CLOCK / DATE

Manually set the clock, clock format and daylight saving time in the **CLOCK** sub-menu, and date in the **DATE** sub-menu.

CLEAN SCREEN

Disable the touchscreen for 30 seconds so you can clean it.

TEMP SCALE

Choose Fahrenheit or Celsius.

RESET

Schedule: Resets to the default Monday-Friday, Saturday-Sunday local thermostat schedule.

EQMP STATUS

View current status of your heating or cooling equipment.

DEVICE INFO

View your thermostat's device information, such as Z-Wave power mode, Z-Wave node, home ID, and model number.

ALERTS

View, snooze or dismiss active alerts and reminders (available only when you see the active alert symbol  on the thermostat home screen).

Navigating the menus

Menu: Touch to access all options and sub-menus.

 or : Touch to page through options and sub-menus.

 or : Touch to adjust things such as temperature, time and date.

Back or **Cancel:** Touch to discard changes or go back to the previous menu.

Select: Touch to access a sub-menu.

Done: Touch to confirm selection.

Tip: You can touch **Select** to access a sub-menu, or you can touch the text in the message area (the word SCHEDULE, for example).

Scheduling options

This thermostat may be configured to be programmable or non programmable.

Thermostat schedule is an optional menu item. It will only show up in the thermostat menu if enabled by your heating or cooling professional. It provides setting for local thermostat schedule control.

Once the thermostat is included into Z-Wave network, it assumes to be programmed from your Z-Wave controller and the program schedule on the thermostat is turned OFF by default.

- Only Home and Away periods appear on the thermostat home screen.
- Home temperature settings are adjustable on the thermostat Home screen. Common for all days.
- Away mode is an Energy saving mode adjustable in the thermostat **MENU/AWAY SETTING**. Common for all days.

See table below with default, adjustable settings:

Thermostat schedule is turned OFF , thermostat included in Z-Wave network			
Period	Start Time	Heat	Cool
Away	N/A*	62°	85°
Home	N/A*	72°	78°

*Triggered by Z-Wave controller

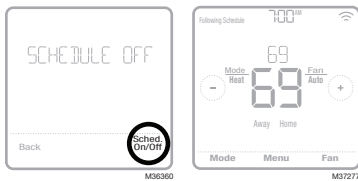

Enabling thermostat schedule when thermostat is included in Z-Wave network (optional):

Z-Wave controllers from various manufacturers may or may not support the Z-Wave Thermostat General V2 Device class used by the T6 Pro Z-Wave Thermostat. If your controller does not support full thermostat device class functions, it may still be able to control basic Home/Away (Energy Saving) modes of the thermostat through basic Z-Wave commands (On/Off) used by the controller for other Z-Wave devices (eg. lighting devices). When only basic commands capable to receive from controller, you can enable the local thermostat schedule to differentiate between temperatures when you are away and when you are at home to differentiate between home and sleep temperatures.

- Home, Away and Sleep periods appear on the thermostat home screen.
- Home and Sleep temperature and time settings are adjustable in the thermostat **MENU/SCHEDULE**.
- Away mode is an Energy saving mode adjustable in the thermostat **MENU/AWAY SETTING**. Common for all days.

See table below with default 5+2 schedule (Mon-Fri; Sat-Sun), adjustable settings:

Thermostat schedule is turned ON , thermostat included in Z-Wave network					
Period	Start Time	Heat (Mon-Fri)	Cool (Mon-Fri)	Heat (Sat-Sun)	Cool (Sat-Sun)
Away	N/A*	62°	85°	62°	85°
Home	6:00 AM	70°	78°	70°	78°
Sleep	10:00 PM	62°	85°	62°	85°

*Triggered by Z-Wave controller

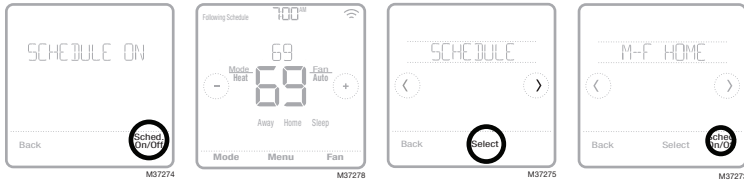

- If the Schedule menu on the thermostat does not appear, make sure that thermostat schedule is enabled by your heating or cooling professional in the thermostat Installer setup menu. This menu also allows to choose from pre-defined different thermostat program schedules such as all days the same, different weekdays and weekends, individual days to be adjustable in the thermostat **MENU/SCHEDULE**.

Program schedule on the thermostat when not included in Z-Wave network (not operated by Z-Wave controller):

The T6 Pro Z-Wave thermostat will function as fully programmable thermostat when not operated by your controller. Each day can be programmed for different heating and cooling settings in 4 unique periods (Wake, Away, Home, Sleep) in the thermostat **MENU/SCHEDULE**. Make sure that thermostat schedule is enabled by your heating or cooling professional in the thermostat Installer setup menu.

See table below with default 5+2 schedule (Mon-Fri; Sat-Sun), adjustable settings:

Thermostat schedule is turned ON , thermostat excluded from Z-Wave network					
Period	Start Time	Heat (Mon-Fri)	Cool (Mon-Fri)	Heat (Sat-Sun)	Cool (Sat-Sun)
Wake	6:00 AM	70°	78°	70°	78°
Away	8:00 AM	62°	85°	62°	85°
Home	6:00 PM	70°	78°	70°	78°
Sleep	10:00 PM	62°	85°	62°	85°



- Wake, Away, Home, Sleep periods appear on the thermostat home screen.
- Temperature settings for all four periods, different per days or group of days are adjustable in thermostat **MENU/SCHEDULE**.

Schedule period

An active period is shown underlined on the thermostat home screen. Periods shown varies on whether thermostat is included in Z-Wave network and whether local thermostat schedule is enabled and turned On.

Thermostat INCLUDED in Z-Wave network:

- 1 Thermostat schedule is turned OFF: Away, Home periods are displayed.
- 2 Thermostat schedule is turned ON: Away, Home, Sleep periods are displayed.

Thermostat EXCLUDED from Z-Wave network:

- 1 Thermostat schedule is turned OFF: Schedule periods are not displayed.
- 2 Thermostat schedule is turned ON: Wake, Away, Home, Sleep periods are displayed.

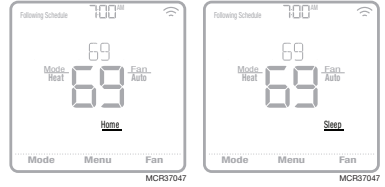
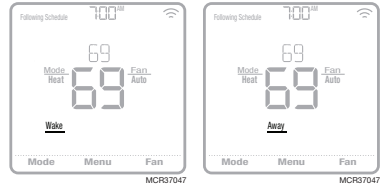

Setting a schedule

To edit a schedule on the thermostat screen, follow the steps below.

- 1 Touch **Menu** on the thermostat home screen.
- 2 Touch the ⏪ or ⏩ arrows until you see SCHEDULE, then touch **Select**.
- 3 Touch the ⏪ or ⏩ arrows to select a period in a day or set of days, then touch **Select** on the period you want to edit.
- 4 Touch the time area, then touch + or - to adjust when the period starts. Touch **Select** to confirm.
- 5 Touch the temperature area, then touch + or - to adjust your preferred temperature for the mode that's currently active (either heating or cooling). Touch **Select** to confirm. Then touch + or - to adjust your preferred temperature for the inactive mode. Touch **Select** to confirm.
- 6 Edit the next period or use the ⏩ until you see **DONE**, then press **Select** to save changes and go to the home screen.

NOTE: Schedule menu is available only if enabled in the thermostat Installer setup menu.

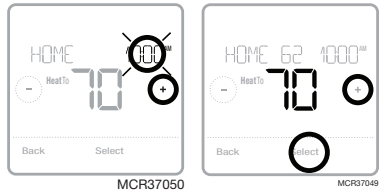
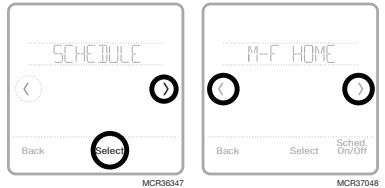

Reset schedule

To reset the thermostat schedule back to the default temperature settings (see "Scheduling options" on page 12), follow steps below.

- 1 Touch **Menu** on the thermostat screen.
- 2 Touch the ⏪ or ⏩ arrows until you see RESET, then touch **Select**.
- 3 Touch the ⏪ or ⏩ arrows until you see SCHEDULE, then touch **Select**.
- 4 Touch **Yes** to confirm. Note:

NOTE: Reset schedule menu option is available only if thermostat schedule enabled in the thermostat Installer setup menu.

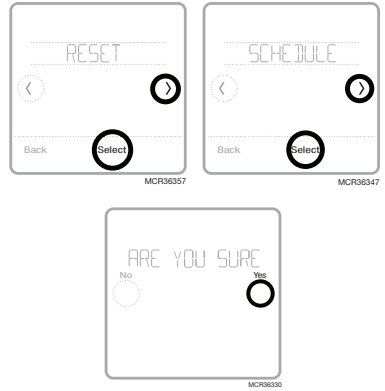

Screen lock settings

To prevent unauthorized access to the thermostat, or to limit changes to the system settings, there are two screen lock settings you can apply.

- **Partial lock:** Only the temperature can be changed.
- **Full lock:** No access is allowed without a PIN number.

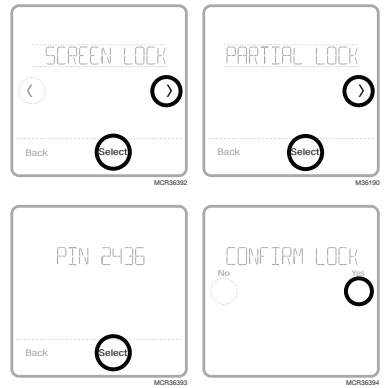

Applying a screen lock setting

- 1 Touch **Menu** on the thermostat home screen.
- 2 Touch the ⏪ or ⏩ arrows until you see SCREEN LOCK, then touch **Select**.
- 3 Touch the ⏪ or ⏩ arrows to select your desired screen lock setting, then touch **Select**.
- 4 A PIN number will appear on screen. Write it down and keep it in a safe place for later reference.
- 5 Touch **Select**, and confirm your screen lock setting by touching **Yes**.



A partially or fully locked screen will be indicated by a lock symbol at the bottom of the thermostat screen.

Unlocking the screen



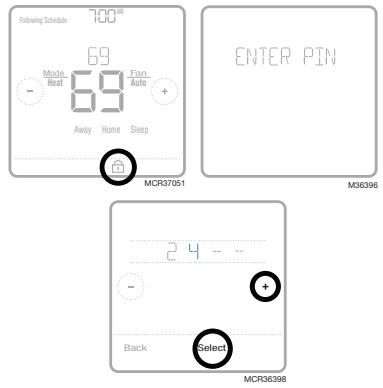

- 1 Touch the lock symbol  on the thermostat home screen.
- 2 When prompted to enter a PIN number, touch  or  to select the first number of the PIN code. Touch Select to confirm, and repeat for the remaining numbers.

When you enter the correct PIN, you'll return to the thermostat home screen. To re-lock the screen after you're done making changes, follow the steps above to apply a lock setting.



Adjusting backlight brightness

When the thermostat is in idle mode, you can adjust how bright you'd like the screen. You can choose a brightness level from 00 (display backlight is off, which is the default) up to 05 (maximum brightness). To adjust backlight brightness, follow the steps below.

- 1 Touch **Menu** on the thermostat home screen.
- 2 Touch the  or  arrows until you see BRIGHTNESS, then touch **Select**.
- 3 Touch  or  to adjust the brightness level, which will change immediately.
- 4 Touch **Done** to confirm.

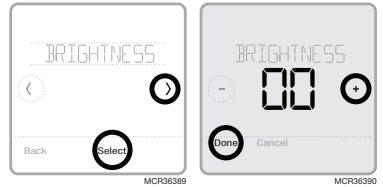

NOTE: This setting is only available if thermostat is powered by 24 VAC. This setting only applies to times when thermostat is not touched. When adjusting settings thermostat is always at full brightness.

Enabling/disabling Adaptive Intelligent Recovery

Over time, your T6 Pro Z-Wave thermostat will learn how long it takes your system to reach the desired temperature. It can then turn on your heating or cooling equipment at the right time to make sure your home is comfortable by the time you expect. This feature is available only if thermostat schedule is enabled in the thermostat Installer setup menu and turned On. To disable it follow steps below:

- 1 Touch **Menu** on the thermostat home screen.
- 2 Touch the ◀ or ▶ arrows until you see RECOVERY, then touch **Select**.
- 3 Touch the ◀ or ▶ arrows to select RECOVERY ON or RECOVERY OFF, then touch **Done** to confirm.

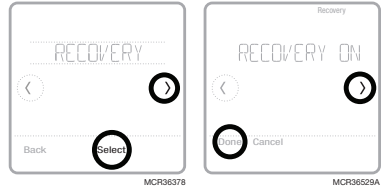

When Adaptive Intelligent Recovery is active, you'll see the recovery symbol in the upper-right corner of the thermostat screen.



Setting the time and date

Setting the time

- 1 Touch **Menu** on the thermostat home screen.
- 2 Touch the ◀ or ▶ arrows until you see CLOCK, then touch **Select**.
- 3 Touch the ◀ or ▶ arrows until you see SET TIME, then touch **Select**.
- 4 Press + or - to set the time (or press and hold the buttons to move more quickly). Touch **Done** when finished.
- 5 Set clock format (12 hours or 24 hours) and daylight saving time in the same CLOCK sub-menu.

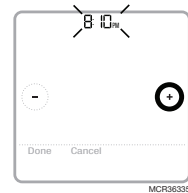

Setting the date

- 1 Touch **Menu** on the thermostat home screen.
- 2 Touch the ◀ or ▶ arrows until you see DATE, then touch **Select**.
- 3 Touch + or - to set the month, then touch **Select** to confirm.
- 4 Continue to set day and year in the same way. Touch **Select** to save your changes.

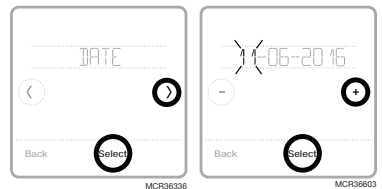

Cleaning the thermostat screen

With the clean screen option, you can lock the thermostat screen so you don't accidentally change your settings when you clean. Follow the steps below to activate clean screen mode.

- 1 Touch **Menu** on the thermostat home screen.
- 2 Touch the ◀ or ▶ arrows until you see CLEAN SCREEN, then touch **Select**.

The screen will deactivate for 30 seconds. A countdown timer will display the amount of time until screen reactivation.

Tip: To clean the thermostat screen, spray water or household cleaner onto a cloth, then use the cloth to clean the screen. Avoid abrasive cleaners and do NOT spray liquid directly on the thermostat.

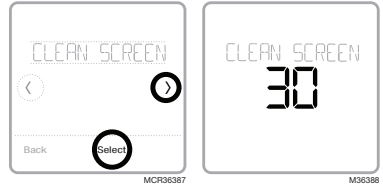

Choosing Fahrenheit or Celsius

To select a temperature scale, follow the steps below.

- 1 Touch **Menu** on the thermostat home screen.
- 2 Touch the ◀ or ▶ arrows until you see TEMP SCALE, then touch **Select**.
- 3 Touch the ◀ or ▶ arrows to select FAHRENHEIT or CELSIUS then touch **Done** to save your changes.
- 4 Touch **Back** to return to the thermostat home screen.

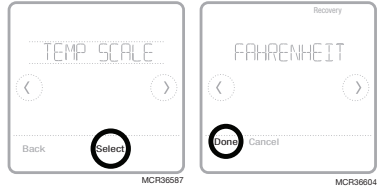

Viewing equipment status

You can check the status of your heating or cooling equipment and fan by following the steps below. Please note that system data may vary depending on thermostat model and how the thermostat was installed.

- 1 Touch **Menu** on the thermostat home screen.
- 2 Touch the ◀ or ▶ arrows until you see EQMT STATUS, then touch **Select**.
- 3 Touch the ◀ or ▶ arrows to select which system you want status information on.

After 3 seconds, system status information will scroll on the screen.

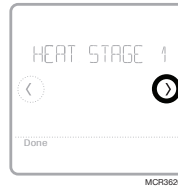
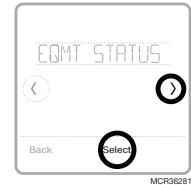

Viewing thermostat information

To see your thermostat's technical information, follow the steps below.

- 1 Touch **Menu** on the thermostat home screen.
- 2 Touch the ◀ or ▶ arrows until you see DEVICE INFO, then touch **Select**.
- 3 Touch the ◀ or ▶ arrows to view information such as:
 - Model Number
 - Power Mode
 - Z-Wave Node ID
 - Z-Wave Home ID
 - Serial Number
 - Date code
 - Firmware version
 - Z-Wave Firmware version
 - Z-Wave library



Battery replacement

Batteries are optional (to provide backup power) if your thermostat was wired to run on 24 VAC power when installed. If your thermostat was wired to run on 24 VAC power, then batteries are NOT required.

Install fresh batteries immediately when the low battery alert appears. The alert appears about two months before the batteries are depleted.

Even if the low battery alert does not appear, you should replace batteries once a year, or before leaving home for more than a month.

If batteries are inserted within two minutes, the time and day will not have to be reset. All other settings are permanently stored in memory, and do not require battery power.

NOTES:

- When replacing batteries, alkaline batteries are recommended.
- When the battery power is low, the thermostat's backlight is disabled to save battery power.
- When battery power is critically low, only the alert icon and the battery icon are displayed, and the thermostat cannot control your HVAC system. Batteries must be replaced immediately.



When the low battery alert appears, press gently to loosen the thermostat and then carefully pull it from the wall mount.

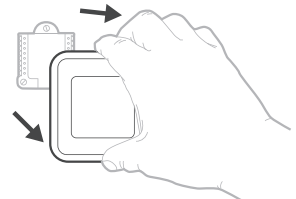

MCR36202

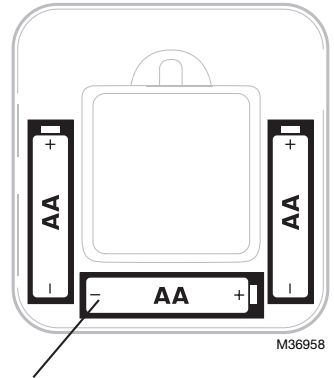

M36958

Insert fresh alkaline AA batteries and reinstall thermostat. Match the polarity of the batteries with the + / - marks inside the battery compartment.

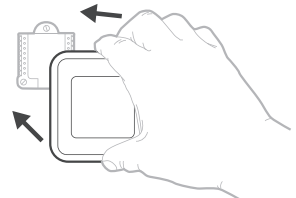



MCR36201

Alerts and maintenance reminders

The T6 Pro Z-Wave thermostat comes with a set of Smart Alerts and Reminders that helps keep your heating and cooling system running correctly and efficiently. If Smart Reminders are set up by your heating or cooling professional, you can get reminded when it's time to change the filter or when your system is not running correctly.

Non-critical alerts and maintenance reminders can be snoozed for up to 7 days and/or dismissed. Some critical alerts cannot be snoozed or dismissed as your heating or cooling system may require service.

When there's an active alert or maintenance reminder, you'll see the alert symbol  on the thermostat home screen. To see alert information, follow the steps below.

- 1 Touch **Menu** on the thermostat home screen, then you'll see the ALERTS sub-menu. (The ALERTS sub-menu will only be available when there's an active alert.)
- 2 Touch **Select** to view the alert. A 3-digit alert code will appear by the thermostat's clock and a description of the alert will scroll on the screen.
- 3 If the alert is non-critical, you'll have the option to Snooze or Dismiss it. If you have multiple alerts, touch the  or  arrows to page through the list of active alerts and follow steps 1 and 2 above.

To see what each 3-digit alert code means and the action you should take, refer to the chart below.

Number	Alert/Reminder	Definition
54	Thermostat Humidity Sensor Error	The sensor of the thermostat has encountered an error. Please contact dealer to replace the thermostat.
164	Heat Pump Needs Service	Heat pump needs service. Contact dealer to diagnose and service heat pump.
170	Internal Memory Error	The memory of the thermostat has encountered an error. Please contact dealer for assistance.
171	Set the Date and Time	Set the date and time on your thermostat. The date and time are required for certain features to operate, like the program schedule.
173	Thermostat Temperature Sensor Error	The sensor of the thermostat has encountered an error. Please contact dealer to replace the Thermostat.
177	Indoor Temperature Sensor Error	Wired indoor temperature sensor is not connected or there is a wiring short. Please contact dealer for assistance.
178	Outdoor Temperature Sensor Error	Wired outdoor temperature sensor is not connected or there is a wiring short. Please contact dealer for assistance.
181	Replace Air Filter (1)	Replace air filter (1). Reset the timer by touching the "dismiss" button on thermostat screen after it is replaced.
182	Replace Air Filter (2)	Replace air filter (2). Reset the timer by touching the "dismiss" button on thermostat screen after it is replaced.

Number	Alert/Reminder	Definition
184	Replace Humidifier Pad	Replace humidifier pad. Reset the timer by touching the "dismiss" button on the thermostat screen after it is replaced.
185	Replace Dehumidifier Filter	Replace the dehumidifier filter. Reset the timer by touching "dismiss" button on thermostat screen after it is replaced.
187	Clean or Replace Ventilator Filter	Clean or replace ventilator filter. Reset the timer by touching the "dismiss" button on thermostat screen after it is replaced.
188	Replace UV Bulb (1)	Replace UV Bulb (1). Reset the timer by touching the "dismiss" button on thermostat screen after it is replaced.
189	Replace UV Bulb (2)	Replace UV Bulb (2). Reset the timer by touching the "dismiss" button on thermostat screen after it is replaced.
252	AC Power Lost	If batteries used as backup power it will drain batteries quickly and Z-Wave communication needs to be turned off. The working power mode can only be changed when thermostat is NOT included in a Z-Wave network. Either to exclude and include thermostat into Z-Wave network to change the power mode to LSS (power-save, sleep mode) or to resume AC power. You can check the actual power mode in the thermostat MENU/DEVICE INFO .
405	Battery Low	Battery low. Please turn the system mode to off and replace the batteries.
407	Battery Critical	Battery critical. Thermostat cannot control your system. Please replace the batteries immediately.
546	Z-Wave Not Configured	Z-Wave has not been configured yet to receive commands from your Z-Wave network. Please follow steps on how to include thermostat into Z-Wave network.
547	Z-Wave Radio Error	Z-Wave module is not operating. Thermostat cannot receive commands from your Z-Wave network. Please contact dealer to replace the thermostat.

Troubleshooting

Screen is blank

- Check circuit breaker and reset if necessary.
- Make sure power switch at heating and cooling system is on.
- Make sure furnace door is closed securely.
- If only battery powered, make sure the batteries are fresh and correctly inserted.

Screen is difficult to read

- Change screen brightness in thermostat **Menu**. Increase brightness intensity for inactive backlight of the thermostat screen (max. is level 5). Setting is only available if thermostat is AC powered

Heating or cooling system does not respond

- Touch **Mode** to set system to Heat. Make sure the temperature is set higher than the Inside temperature.
- Touch **Mode** to set system to Cool. Make sure the temperature is set lower than the Inside temperature.
- Check circuit breaker and reset if necessary.
- Make sure power switch at heating & cooling system is on.
- Make sure furnace door is closed securely.

Temperature settings do not change

Your installer may have set a range stop setting for heat or cooling. Contact your installer to verify the range stop settings on the thermostat. Default range stops settings are:

- Heat: 40 °F to 90 °F (4.5 °C to 32.0 °C)
- Cool: 50 °F to 99 °F (10.0 °C to 37.0 °C)

“Cool On” or “Heat On” is flashing

- Compressor protection feature is engaged. Wait 5 minutes for the system to restart safely, without damage to the compressor (see page 8).

5-year warranty

Resideo warrants this product, excluding battery, to be free from defects in workmanship or materials, under normal use and service, for a period of five (5) years from the date of first purchase by the original purchaser. If at any time during the warranty period the product is determined to be defective due to workmanship or materials, Resideo shall repair or replace it (at Resideo's option).

If the product is defective,

(i) return it, with a bill of sale or other dated proof of purchase, to the place from which you purchased it; or

(ii) call Resideo Customer Care at 1-800-468-1502. Customer Care will make the determination whether the product should be returned to the following address: Resideo Return Goods, 1985 Douglas Dr. N., Golden Valley, MN 55422, or whether a replacement product can be sent to you.

This warranty does not cover removal or reinstallation costs. This warranty shall not apply if it is shown by Resideo that the defect was caused by damage which occurred while the product was in the possession of a consumer.

Resideo's sole responsibility shall be to repair or replace the product within the terms stated above. RESIDEO SHALL NOT BE LIABLE FOR ANY LOSS OR DAMAGE OF ANY KIND, INCLUDING ANY INCIDENTAL OR CONSEQUENTIAL DAMAGES RESULTING, DIRECTLY OR INDIRECTLY, FROM ANY BREACH OF ANY WARRANTY, EXPRESS OR IMPLIED, OR ANY OTHER FAILURE OF THIS PRODUCT.

Some states do not allow the exclusion or limitation of incidental or consequential damages, so this limitation may not apply to you.

THIS WARRANTY IS THE ONLY EXPRESS WARRANTY RESIDEO MAKES ON THIS PRODUCT. THE DURATION OF ANY IMPLIED WARRANTIES, INCLUDING THE WARRANTIES OF MERCHANTABILITY AND FITNESS FOR A PARTICULAR PURPOSE, IS HEREBY LIMITED TO THE FIVE YEAR DURATION OF THIS WARRANTY. Some states do not allow limitations on how long an implied warranty lasts, so the above limitation may not apply to you.

This warranty gives you specific legal rights, and you may have other rights which vary from state to state. If you have any questions concerning this warranty, please write Resideo Customer Care, 1985 Douglas Dr, Golden Valley, MN 55422 or call 1-800-468-1502.

General system information



CAUTION: ELECTRICAL HAZARD

Can cause electrical shock or equipment damage. Disconnect power before beginning installation.



CAUTION: EQUIPMENT DAMAGE HAZARD

Compressor protection is bypassed during testing. To prevent equipment damage, avoid cycling the compressor quickly.



CAUTION: MERCURY NOTICE

If the T6 Pro Z-Wave thermostat is replacing a thermostat that contains mercury in a sealed tube, do not place the old thermostat in the trash. Please contact your local waste management authority for proper recycling or disposal instructions.



CAUTION: ELECTRONIC WASTE NOTICE

The product should not be disposed of with other household waste. Check for the nearest authorized collection centers or authorized recyclers. The correct disposal of end-of-life equipment will help prevent potential negative consequences for the environment and human health.

Regulatory information

FCC REGULATIONS

§ 15.19 (a)(3)

This device complies with part 15 of the FCC Rules. Operation is subject to the following two conditions:

- This device may not cause harmful interference, and
- This device must accept any interference received, including interference that may cause undesired operation.

IC REGULATIONS

RSS-GEN

This device complies with Industry Canada's license-exempt RSSs.

Operation is subject to the following two conditions:

- This device may not cause interference; and
- This device must accept any interference, including interference that may cause undesired operation of the device.

FCC Warning (Part 15.21) (USA only)

Changes or modifications not expressly approved by the party responsible for compliance could void the user's authority to operate the equipment.



Resideo Technologies, Inc.
1985 Douglas Drive North, Golden Valley, MN 55422
1-800-468-1502
33-00588EFS-03 M.S. 03-22 | Printed in United States



33-00588EFS-03

© 2022 Resideo Technologies, Inc. All rights reserved.

The Honeywell Home trademark is used under license from Honeywell International, Inc. This product is manufactured by Resideo Technologies, Inc. and its affiliates.

La marque de commerce Honeywell Home est utilisée avec l'autorisation d'Honeywell International, Inc.

Ce produit est fabriqué par Resideo Technologies, Inc. et ses sociétés affiliées.

Todos los derechos reservados. La marca comercial Honeywell Home se utiliza bajo licencia de Honeywell International, Inc.

Este producto es fabricado por Resideo Technologies, Inc. y sus afiliados.