

WIRING INSTRUCTIONS

TITLE

PISTOL GRIP TOOLS

BULLETIN
58-01-0021

MILWAUKEE ELECTRIC TOOL CORP. 13135 WEST LISBON RD. BROOKFIELD, WIS.

DATE
June '92

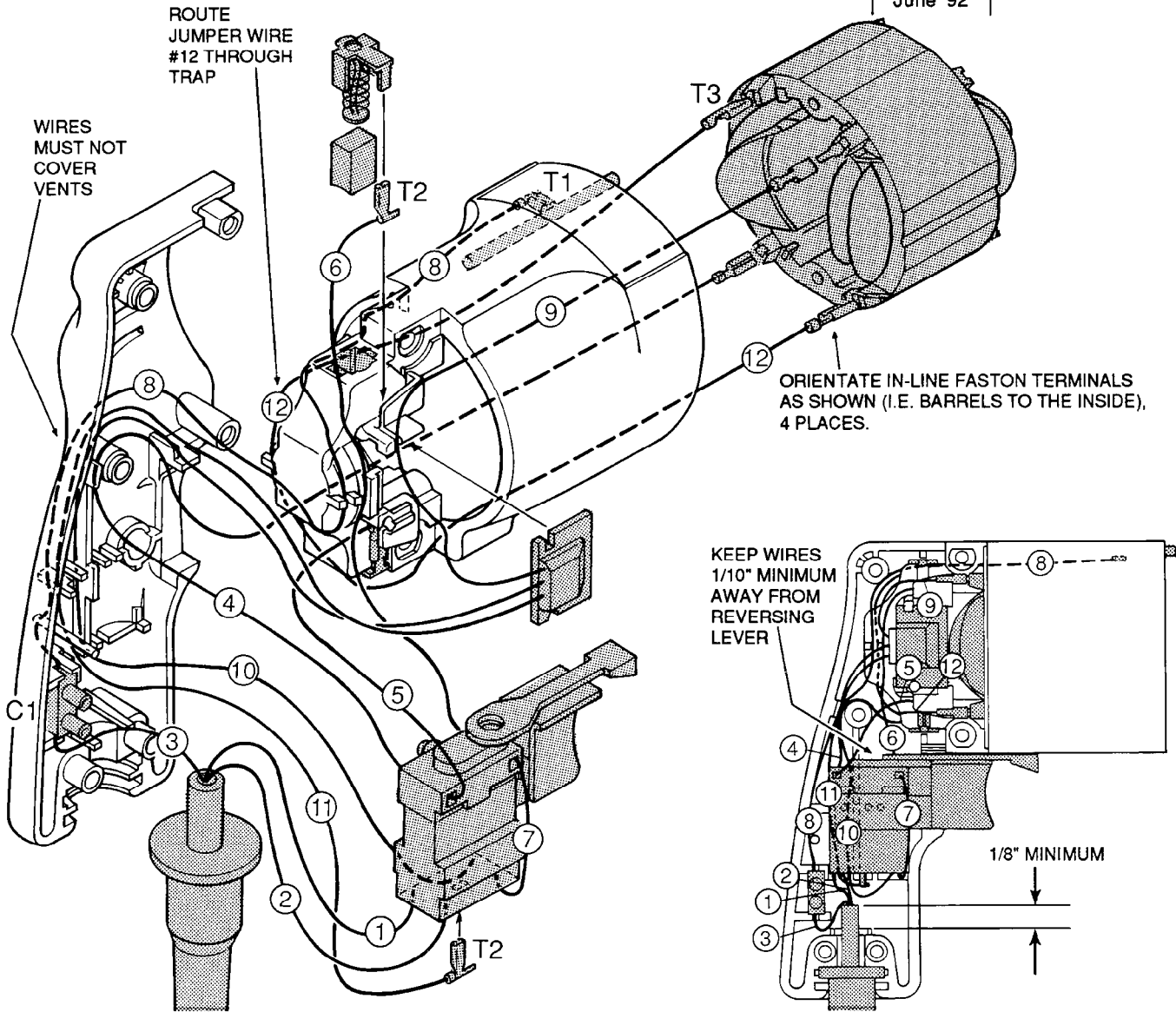

WIRING SPECIFICATIONS

Wire No.	Wire Color	Origin or Part No.	Gauge	Length	Terminals, Connectors and End Wire Preparation
1	Black	Cord	18	1-1/2"	Strip 5/16" and tin.
2	White	Cord	18	1-1/2"	Strip 5/16" and tin.
▲ 3	Green	Cord	18	1-1/2"	Strip 3/16" for C1.
4	Blue	23-94-6270	18*	3-1/8"	Strip 5/32" for T3 / Strip 3/16" and tin.
5	White	23-94-6280	18*	3-1/8"	Strip 3/16" for T2 / Strip 3/16" and tin.
6	Black	23-94-6275	18*	4-1/2"	Strip 3/16" for T2 / Strip 3/16" and tin.
7	Black	Switch	---	---	Supplied with switch.
▲ 8	Green	23-94-6225	16*	9-1/2"	Strip 3/16" for T1 / Strip 3/16" for C1.
9	Black	Module	18*	1-5/8"	Strip 5/32" for T3.
10	Black	Module	18*	6-3/8"	Strip 5/16" and tin.
11	Black	Module	18*	6-3/8"	Strip 3/16" for T2.
12	Black	23-94-6265	18*	3-3/4"	Strip 5/32" for T3 on both ends.

BULK LEAD WIRE - BULLETIN 58-01-0003

▲ FOR DOUBLE INSULATED, DISREGARD WIRES AND TERMINALS

NOTE:

All leads must be held to $\pm 1/8"$.
All lead lengths are before stripping.

TERMINAL DESCRIPTION

Code	Part No.	Qty.
▲ T1	23-74-0605	1
T2	23-74-0900	3
T3	23-74-1060	4

CONNECTOR DESCRIPTION

▲ C1	22-56-0456	1
------	------------	---