

OASIS® Water Coolers

VERSAFILLER®

Model PWSMSBF and PWSMFSBF

Installation Instructions

The Sports VersaFiller is an extension of the Aqua Pointe® product line.

No electrical connections are required.

The VersaFiller is shipped partially assembled.

When completed, the finished assembly will look like this:



Section 1: Getting Started

What's Included:

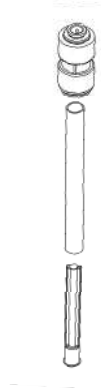

Fitting, reducing union

4" straight copper tube

Inline strainer

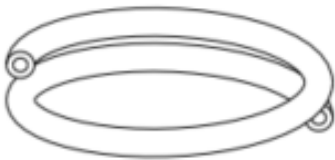

Tubing insulation



Versafilter III

Versafilter III is only included
on the PWSMF SBF model

Tools required:

- #15 torx bit driver

Section 2: Rough In Drawing

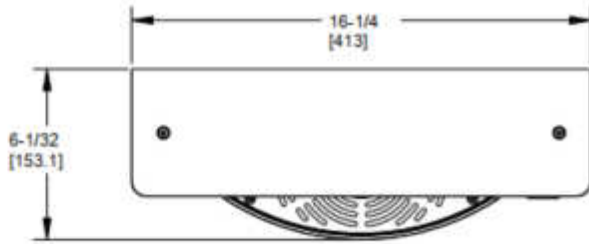

NOTES:

- * 1. RECOMMENDED ADULT BARRIER FREE HEIGHT INSTALLATION SHOWN. ADJUST VERTICAL DIMENSIONS AS REQUIRED TO COMPLY WITH FEDERAL, STATE AND LOCAL CODES.
- 2. 3/8 O.D. WATER INLET WITH STRAINER PROVIDED.
- 3. STOP VALVE, TRAP, PIPE CONNECTOR TO WASTE LINE AND 3/8 COMPRESSION FITTING NOT PROVIDED.
- 4. ALL DIMENSIONS ARE IN INCHES. DIMENSIONS IN BRACKETS [] ARE IN MILLIMETERS.

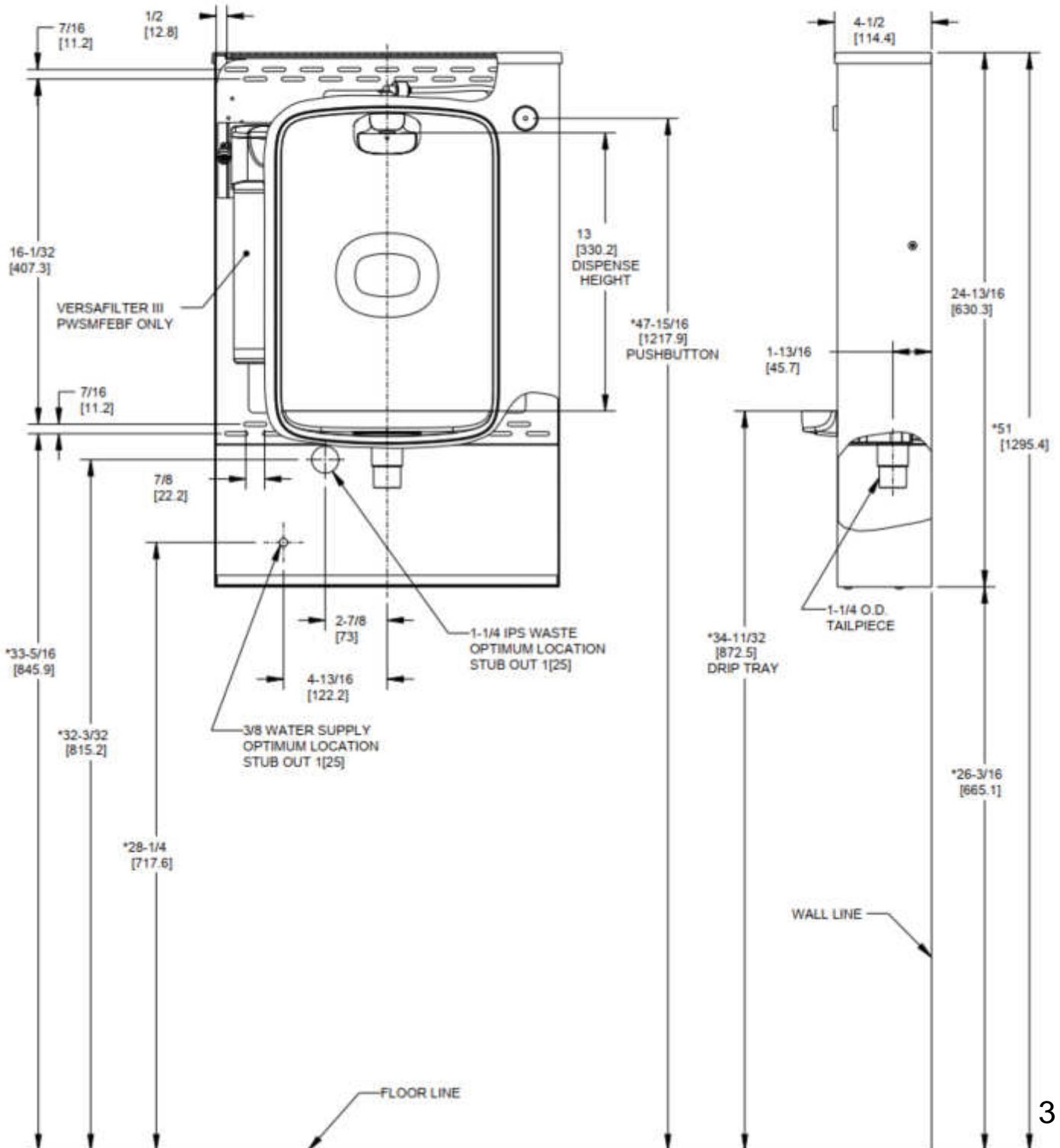

Section 3: Plumbing Diagram

Plumbing Diagram

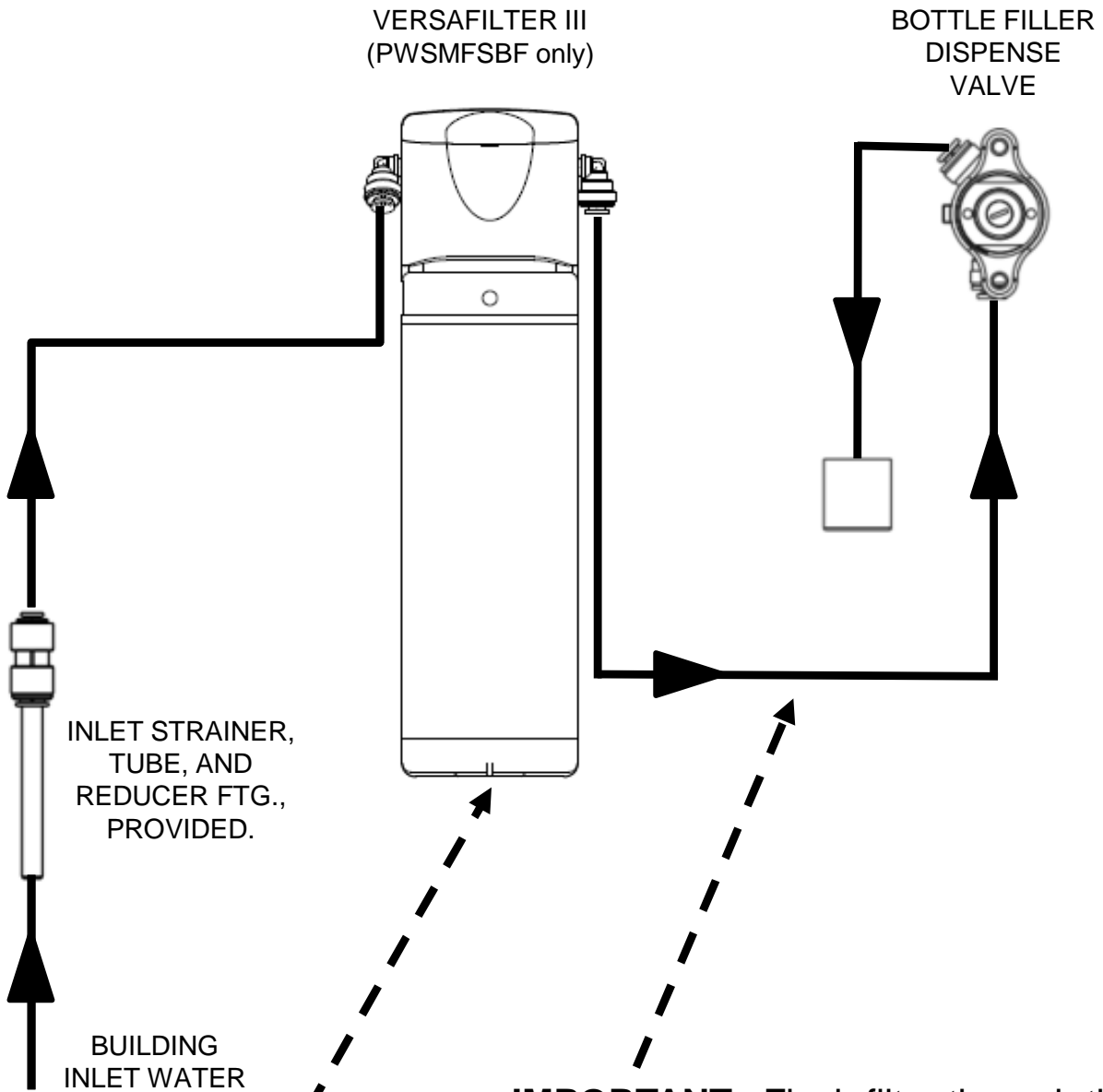

IMPORTANT: Flush filter through this water line before connecting water line to bottle filler dispense valve.

IMPORTANT: When replacing filter cartridge, depressurize water lines prior to removal of filter housing from the quarter turn filter head assembly.

Section 4: Installation

A. INSPECTION

Inspect the cartons and various components for evidence of rough handling and concealed damage. Damage claims should be filed with the carrier.

B. INSTALLATION & ELECTRICAL / PLUMBING CONNECTIONS

1. **Note:** The following states require a licensed plumber to install cooler; AR, GA, MA, MI, OK, RI, SC, SD, TX, VT and WI.
2. CA, KS, MN, NM, and OR allow for state-registered installer or contractor as well. State and local plumbing codes may prohibit use of saddle tapping valves for water line connection in some applications. All connections must conform to applicable plumbing codes.
3. Plumbing rough-in and wall opening should be prepared as shown on Roughing-in drawing in Section 2. This drinking water cooler is designed to be operated at a water supply line pressure of up to 100 psi (690 kPa). A pressure regulator must be installed prior to the unit's water inlet if the water pressure (including any possible pressure spikes) could exceed 100 psi (690 kPa).
4. Prep the unit for installation by removing the internal wall frame from cabinet. Remove 2 torx screws (T15) from the sides. Save the screws for reassembly later.
5. Place the wall frame in the appropriate location and attach to the wall. Refer to the Rough In Drawing in Section 2. The back panel has 4 rows of slots to provide optimum securing location. NOTE: As the frame is put in place, slide the drain tube into the drain stub extending from the wall.
6. If a chiller is providing cold water to the bottle filler insulate the bottle filler ¼" OD water lines with tubing insulation provided.
7. **For non-filtered models**, connect the water supply line and check for leaks. Proceed to step 9.
8. **For filtered models**, the filter needs to be flushed before turning on the water supply. To do this, disconnect the water line at the dispense valve as shown in the plumbing diagram in Section 3. Direct that water line to the drain. Connect the water supply line and flush the filter until the water is clear. Reconnect the water line to the dispense valve and check all plumbing connections for leaks.
9. Fasten the cabinet to the frame using the 2 torx screws removed earlier.
10. On new plumbing installations, run water through the spout until the water taste is satisfactory.



OASIS INTERNATIONAL

222 East Campus View Blvd. • Columbus, OH 43235 U.S.A.

1-800-646-2747

www.oasiscoolers.com

OASIS, Versafiller, Aqua Pointe and Versafilter are registered trademark of LVD Acquisition, LLC dba Oasis International

© 2023 LVD Acquisition, LLC
030099-689 5/2023