

DUOFIT® In-Wall Tank Unit, 1.28GPF & 0.9GPF

FEATURES

- Dual flush system, low consumption (1.28GPF/4.8LPF & 0.9GPF/3.4LPF)
- Adjustable 15"-19" mounting height
- Support up to 880lbs
- Commercial 2" x 6" or optional residential installation with 2" x 4" wall studs with waste outlet kit
- 1-pc blow molded, insulated polyethylene tank to prevent leaks and sweating
- 2" x 6" Polyethylene outlet included
- Pre-plumbed for WASHLET®+ connection

MODELS

- WT172M - with copper washlet supply line

Required Push Plates (Sold Separately)

- YT920 #MS - Matte Silver
#WH - White
- YT930 #MS - Matte Silver
#WH - White
- YT970 #SS - Stainless Steel
- YT980 #SS - Stainless Steel

Compatible Outlets (Sold Separately)

- THU343 2" x 4" outlet HDPE & PVC
- THU335 2" x 6" outlet cast iron
- THU807 WASHLET connection kit

Compatible Toilet Bowl (Sold Separately)

- CT447CFG, RPT™ Wall-hung toilet
- CT449CFG, SPT™ Wall-hung toilet
- CT437FG, MH™ Wall-hung toilet

PRODUCT SPECIFICATION

This universal height, high-efficiency, dual flushing, in-wall tank system toilet shall be 1.28GPF & 0.9GPF. Requires TOTO toilet model CT447CFG, CT449CFG, or CT437FG. In-Wall tank system shall be TOTO Model WT172M_____.



CODES/STANDARDS

- Meets and exceeds
 - Carrier system: ASME A112.6.2
 - Tank trim: IAPMO PS50, CSA B125.3, ASSE1002
- Certifications: IAPMO(cUPC), *EPA Watersense, State of Massachusetts, City of Los Angeles, and others
- Code compliance: UPC, IPC, NSPC, NPC Canada, and others
- Complies with CA Prop 65 warning requirements



*WaterSense certification only applies to WT172M when combined with either model CT447CFG, CT449CFG, or CT437FG toilet bowls.

WT172M

DUOFIT In-Wall Tank Unit, 1.28GPF & 0.9 GPF

SPECIFICATIONS

- Water Use 1.28GPF & 0.9GPF (4.8LPF & 3.4LPF)
- Flush System Dual-flush
- Min. Water Pressure 8 psi (static)
- Max. Water Pressure 108.75 psi (static)
- Installation Height 15" to 19" (projected range)
- Warranty One Year Limited Warranty
- Material Various
- Shipping Weight 45 lbs
- Shipping Dimensions 47-1/2" x 26" x 6"

INSTALLATION NOTES

Adequate structural bracing is required. Framing support should be capable of supporting 880 lbs load without damage to the wall. See installation manual for more details.

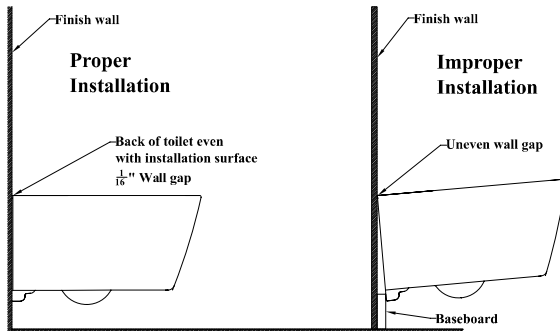

DIMENSIONS

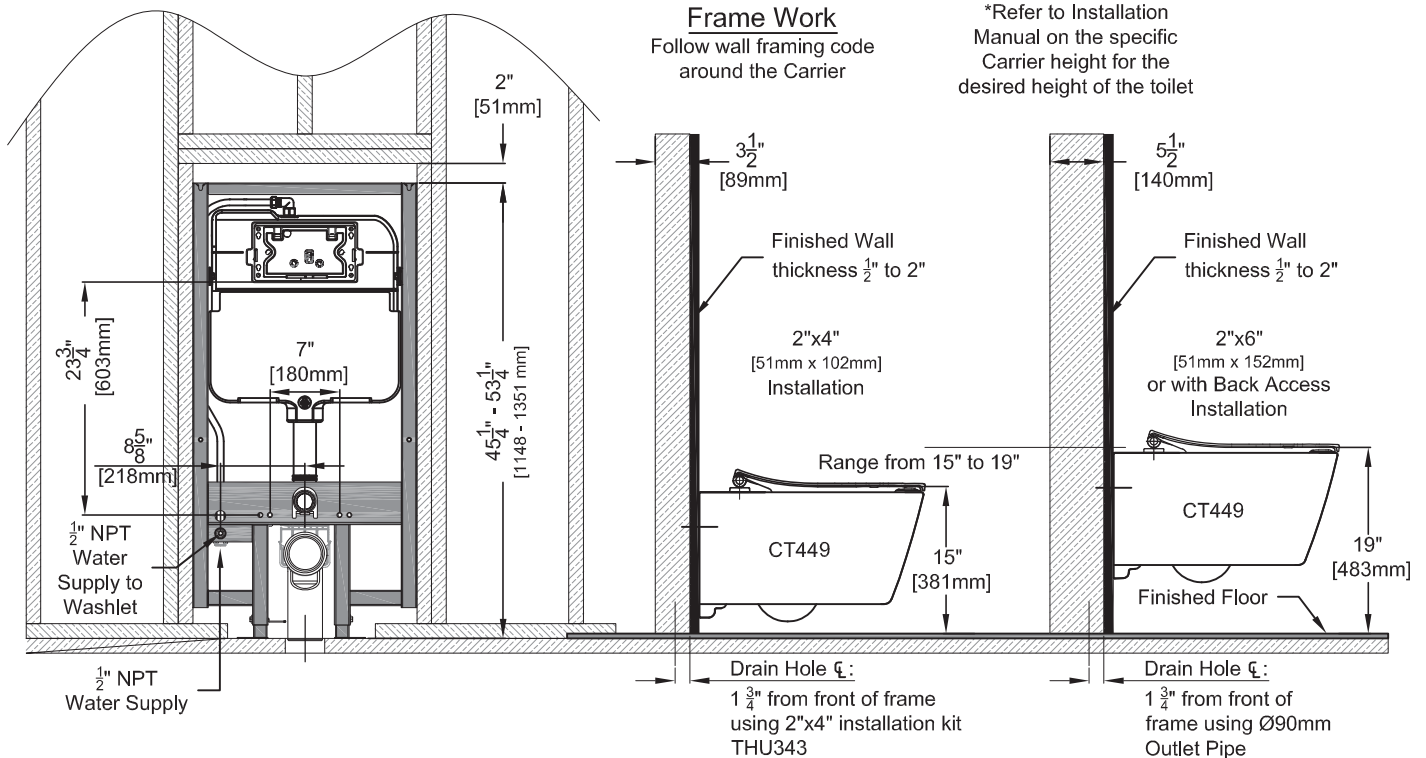

TOTO

These dimensions and specifications are subject to change without notice