

WILLIAMS

Comfort Products

Exploded Views and Replacement Parts List

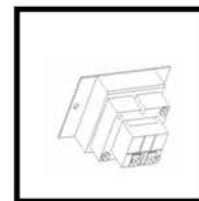
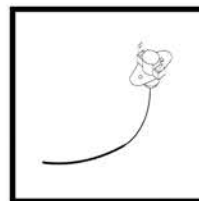
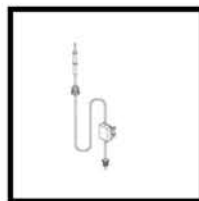
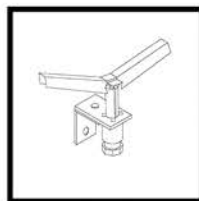
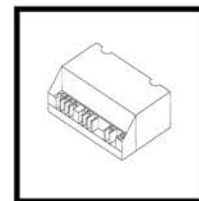
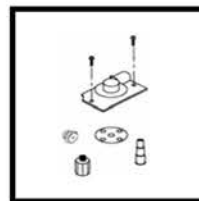
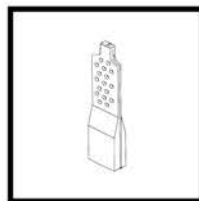
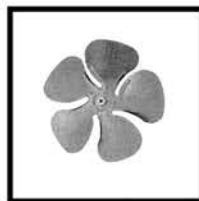

Burner Orifice Sizing Chart

NATURAL GAS							
Model Number	Elevation Sea Level to 2,000'	Model Number	Elevation 2,001 to 4,000'	Model Number	Elevation 4,001 to 6,000'	Model Number	Elevation 6,001 to 8,000'
DIRECT-VENT GRAVITY							
1403822	P090550	1413822	P090551	1433822	P090553	1453822	P090553
2203822	P090544	2213822	P090547	2233822	P090548	2253822	P090550
3003622	P090542	3003622	P090542	3033622	P090544	3053622	P090545
MONTEREY TOP-VENT - 9822 SERIES							
2509822	P332618	2519822	P090544	2539822	P090546	2559822	P090548
3509822	P332636	3519822	P090538	3539822	P090540	3559822	P090543
5009822	P332625	5019822	P090544	5039822	P090545	5059822	P090547
FORSAIRE TOP-VENT							
3508232	P090536	3518232	P090538	3538232	P090540	3558232	P332618
3508632	P090536	3518632	P090537	3538632	P090540	3558632	P090542
5008632*	P090542	5018632*	P090543	5038632*	P090544	5058632*	P090546
5508232*	P332622	5518232*	P322625	5538232*	P090544	5558232*	P090546
6008532A*	P332637	6018532A*	P090540	6038532A*	P090542	6058532A*	P090543
6508632*	P090536	6518632*	P090539	6538632*	P090541	6558632*	P332618
FORSAIRE DIRECT-VENT							
4007332	P090532	4017332	P090535	4037332	P090537	4057332	P090539
4007732	P090532	4017732	P090535	4037732	P090537	4057732	P090539
5507332*	P090541	5517332*	P090542	5537332*	P090543	5557332*	P090544
6007732*	P090538	6017732*	P090540	6037732*	P090542	6057732*	P090544
VENTED ROOM HEATERS							
2001622A	P501781	2011622A	P501771	2031622A	P501802	2051622A	P501782
3501522A	P500336	3511522A	P500338	3531522A	P500341	3551522A	P500342
3501922A	P500336	3511922A	P500338	3531922A	P500341	3551922A	P500342
3502522A	P500336	3512522A	P500338	3532522A	P500341	3552522A	P500342
3502922A	P500336	3512922A	P500338	3532922A	P500341	3552922A	P500342
5001522A	P500360	5011522A	P500331	5031522A	P500332	5051522A	P500334
5001922A	P500360	5011922A	P500331	5031922A	P500332	5051922A	P500334
5002522A	P500360	5012522A	P500331	5032522A	P500332	5052522A	P500334
5002922A	P500360	5012922A	P500331	5032922A	P500332	5052922A	P500334
6501522A	P500327	6511522A	P500328	6531522A	P500329	6551522A	P500360
6501922A	P500327	6511922A	P500328	6531922A	P500329	6551922A	P500360
6502522A	P500327	6512522A	P500328	6532522A	P500329	6552522A	P500360
6502922A	P500327	6512922A	P500328	6532922A	P500329	6552922A	P500360
FLOOR FURNACE							
4505622A	P500331	4515622A	P500332	4535622A	P500335	4555622A	P500336
6005622A	P500329	6015622A	P500362	6035622A	P500364	6055622A	P500365

* Two (2) Orifices Required

